

HM834080F-B

User manual

Ceramic glass hob

Thank you for choosing one of our high-quality products.

To ensure optimal and regular performance of your appliance please read this instruction manual carefully. It will enable you to navigate all processes perfectly and most efficiently. To refer to this manual any time you need to, we recommend you to keep it in a safe place. And please pass it to any future owner of the appliance.

We wish you much joy with your new appliance.

## CONTENTS

<b>SAFETY INFORMATION</b>	2	The child safety device	10
<b>INSTALLATION</b>	3	OffSound Control (Deactivation and activation of the sounds)	10
<b>DESCRIPTION OF THE APPLIANCE</b>	6	<b>HELPFUL HINTS AND TIPS</b>	11
<b>OPERATING THE APPLIANCE</b>	8	<b>CARE AND CLEANING</b>	11
Automatic Switch Off	8	<b>WHAT TO DO IF...</b>	12
/ Switching the outer rings on and off	8	<b>ENVIRONMENT CONCERNS</b>	13
Using the Timer	9	Packaging material	13
Starting the STOP+GO	10		
Locking / unlocking the control panel	10		

Subject to change without notice



## SAFETY INFORMATION



For your safety and correct operation of the appliance, read this manual carefully before installation and use. Always keep these instructions with the appliance even if you move or sell it. Users must fully know the operation and safety features of the appliance.

### General safety



#### **WARNING!**

Persons (including children) with reduced physical sensory, mental capabilities or lack of experience and knowledge must not use the appliance. They must have supervision or instruction for the operation of the appliance by a person responsible for their safety.

### Child safety

- Only adults can use this appliance. Children must get supervision to make sure that they do not play with the appliance.
- Keep all packaging away from children. There is a risk of suffocation.
- Keep children away from the appliance when it is on.



#### **WARNING!**

Start the child safety device to prevent small children and pets from an accidental activation of the appliance.

## Safety during operation

- Remove all packaging, stickers and layers from the appliance before the first use.
- Set the cooking zones to "off" after each use.
- Risk of burns! Do not put cutlery or saucepan lids on the cooking surface, as they can become hot.



### WARNING!

**Fire danger!** Overheated fats and oils can ignite very quickly.

## Correct operation

- Always monitor the appliance during operation.
- Only use the appliance for domestic cooking tasks!
- Do not use the appliance as a work or a storage surface.
- Do not put or keep very flammable liquids and materials, or fusible objects (made of plastic or aluminium) on or near the appliance.
- Be careful when you connect the appliance to the near sockets. Do not let electricity bonds touch the appliance or hot cookware. Do not let electricity bonds tangle.

## How to prevent a damage to the appliance

- If the objects or cookware fall on the glass ceramic, the surface can be damaged.
- Cookware made of cast iron, cast aluminium or with damaged bottoms can scratch the glass ceramic if you move them on the surface.
- Do not let cookware boil dry to prevent the damage to cookware and glass ceramics.
- Do not use the cooking zones with empty cookware or without cookware.
- Do not cover any part of the appliance with aluminium foil.





### WARNING!

**If there is a crack on the surface, disconnect power supply to prevent the electric shock.**

## INSTALLATION

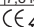

**Before the installation**, note down the serial number (Ser. Nr.) from the rating plate. **The rating plate of the appliance is on its lower casing.**

Modell HM834080F-B	Prod.Nr. 949 593 219 00
Typ 58 HBD C6 A0	220-240 V 50-60-Hz
Made in Germany	Ser.Nr. .... 7,8 kW
AEG-ELECTROLUX	
  	

## Safety instructions



### WARNING!

You must read these!

Fully obey the laws, ordinances, directives and standards in force in the country where you use the appliance (safety regulations, recycling regulations, electrical safety rules etc.)!

Only a qualified electrician must install the appliance!

Keep the minimum distances to other appliances and units!

Install anti-shock protection, for example install the drawers only with a protective floor directly below the appliance!

Protect the cut surfaces of the worktop against moisture with a correct sealant!

Seal the appliance to the work top with no space left with a correct sealant!

Protect the bottom of the appliance from steam and moisture, e.g. from a dishwasher or oven!

Do not install the appliance adjacent to doors and below windows! If not, hot cookware can be hit off the hob when you open doors or windows.



### WARNING!

Risk of injury from electrical current.

The combination appliance is live.

- Observe electrical safety rules.
- Rated voltage of the combined appliances must match.
- Fit plug and socket connections together properly.
- Install correctly to give anti-shock protection.
- Loose and incorrect plug and socket connections can make the terminal become too hot.
- A qualified electrician must install the clamping connections correctly.

The appliance must have the electrical installation which lets you disconnect the appliance from the mains at all poles with a contact opening width of minimum 3 mm.

You must have correct isolation devices: line protecting cut-outs, fuses (screw type fuses removed from the holder), earth leakage trips and contactors.

## Assembly

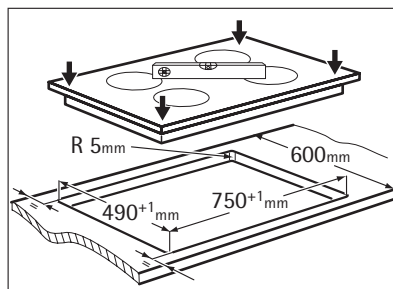
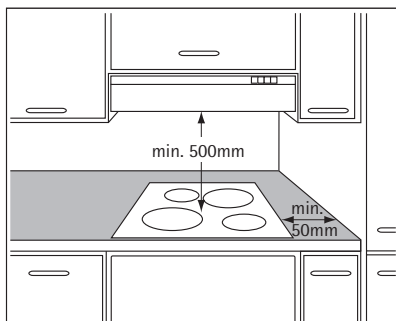

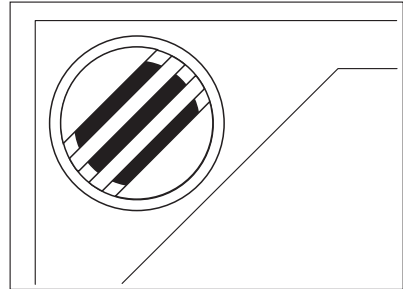
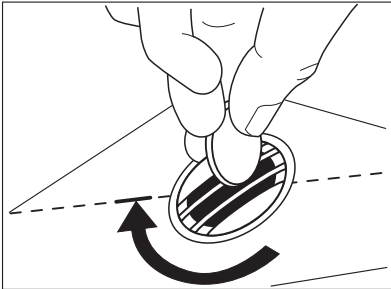
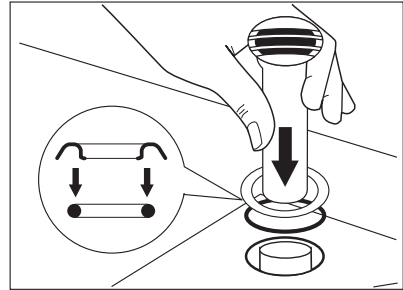
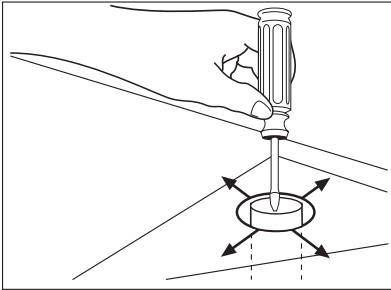
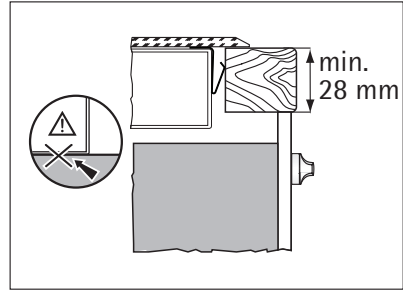
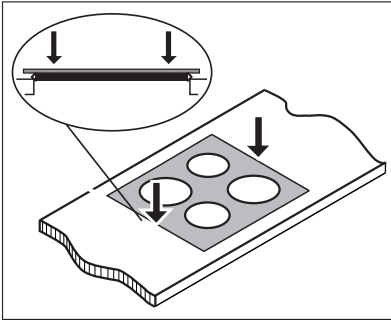

Removal

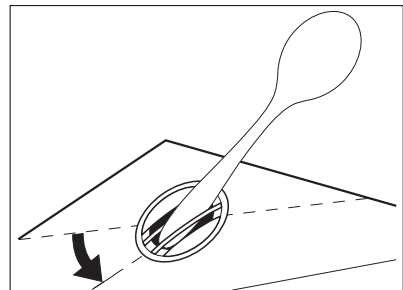
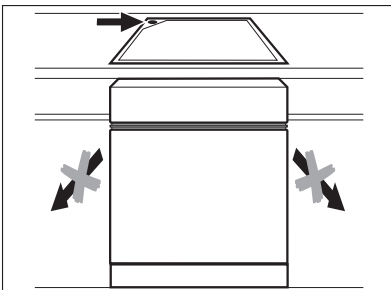

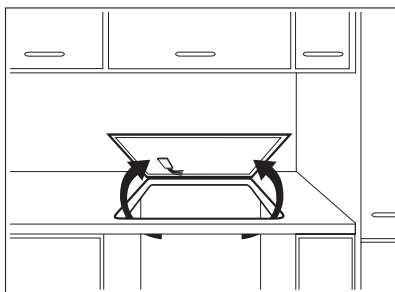
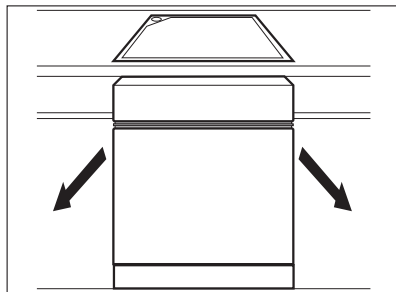
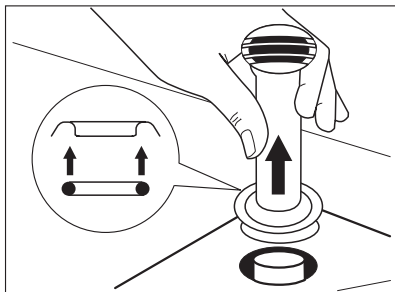

## DESCRIPTION OF THE APPLIANCE

### Cooking surface layout

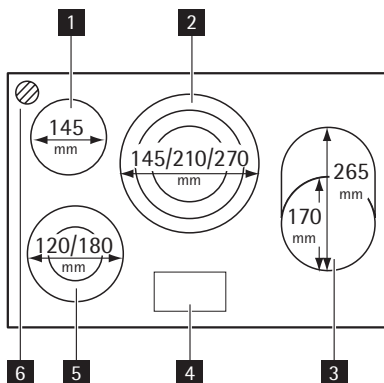

- 1** Single cooking zone 1200 W
- 2** Triple cooking zone 1050/1950/2700 W
- 3** Multi-purpose zone 1400/2200 W
- 4** Control panel
- 5** Double cooking zone 700/1700 W
- 6** Steam outlet

## Control panel layout

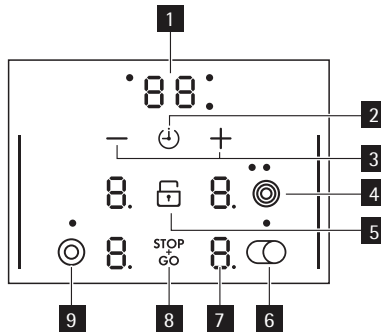

Use the sensor fields to operate the appliance. Indicators, displays and sounds tell which functions operate.

	sensor field	function
1	the timer display	shows the time in minutes
2		selects the cooking zone
3	+ / -	increases or decreases the time
4		starts and stops the outer rings
5		starts and stops the key lock or child lock
6		starts and stops the oval zone
7	a heat setting display	shows the heat setting
8		starts and stops STOP+GO
9		starts and stops the outer ring

## Heat setting displays

Display	Description
	The cooking zone is off
	The cooking zone operates
	Keep Warm
	The automatic heat-up function is on
	There is a malfunction
	Residual heat indicator: still cooking / keep warm / residual heat
	Lock/Child safety function is on
	The automatic switch off is on

## OptiHeat Control (3 step Residual heat indicator)



### WARNING!

☰ / = / \_ Risk of burns from residual heat!

OptiHeat Control indicates the level of the residual heat.

## OPERATING THE APPLIANCE

**You operate the hob with the knobs of the appliance that you installed with the hob. The Operating Instructions chapter for this appliance tells how to operate the hob.**



When a cooking zone operates, it hums for a short time. This is typical of all ceramic glass cooking zones and does not show that the appliance operates incorrectly.

## Automatic Switch Off

The function stops the hob automatically if:

- all cooking zones are off .
- you cover a sensor field with an object (a pan, a cloth, etc.) for longer than 10 seconds. The sound operates some time and the hob stops. Remove the object or clean the control panel.
- you do not stop a cooking zone or change the heat setting. After some time comes on and the hob stops. See the table.

Automatic Switch Off times

Heat setting	,  -	-		-
Stops after	6 hours	5 hours	4 hours	1.5 hours

## / Switching the outer rings on and off

You can match the effective heating surface to the size of the cookware.

To switch on the outer ring touch the sensor field / . The indicator comes on. For more outer rings touch the same sensor field again. The next indicator comes on.

Do the procedure again to switch off the outer ring. The indicator goes out.

## The automatic heat up

Automatic heat up function sets the highest heat setting for some time, and then decreases to the necessary level. To switch it on turn the cooking zone knob to the right until you see in the display. After that set the heat setting immediately.



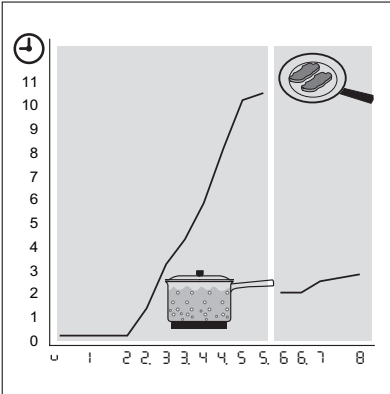

## Using the Timer

### Count Down Timer

Use the Count Down Timer to set how long the cooking zone operates for one cooking session.

**Set the Count Down Timer after the selection of the cooking zone.**

You can set the heat setting before or after you set the timer.

- **Selection of the cooking zone:** touch  $\odot$  again and again until the indicator of a necessary cooking zone comes on.
- **Starting the Count Down Timer:** touch  $+$  of the timer to set the time (  $00 - 99$  minutes). When the indicator of the cooking zone flashes slower, the time counts down.
- **Checking the remaining time:** select the cooking zone with  $\odot$ . The indicator of the cooking zone flashes faster. Display shows the remaining time.
- **Changing the Count Down Timer:** select the cooking zone with  $\odot$  touch  $+$  or  $-$ .
- **Stopping the timer:** select the cooking zone with  $\odot$ . Touch  $-$ . The remaining time counts backwards to  $00$ . The indicator of the cooking zone goes out. To switch off You can also touch  $+$  and  $-$  at the same time.

When the time elapses, the sound operates and  $00$  flashes. The cooking zone switches off.

- **Stopping the sound:** touch  $\odot$

### CountUp Timer (Count up timer)

Use the CountUp Timer to monitor how long the cooking zone operates.

- **Selection of the cooking zone (if more than 1 cooking zone operate):** touch  $\odot$  again and again until the indicator of a necessary cooking zone comes on.
- **Starting the CountUp Timer:** touch  $-$  of the timer  $\updownarrow$  comes on. When the indicator of the cooking zone flashes slower, the time counts up, display switches between  $\updownarrow$  and time elapsed (minutes)
- **Checking the elapsed time:** select the cooking zone with  $\odot$ . The indicator of the cooking zone flashes faster. Display shows the elapsed time.

- **Stopping the CountUp Timer:** select the cooking zone with and touch or to switch off the timer. The indicator of the cooking zone goes out.

Minute Minder

You can use the timer as a **Minute Minder** while cooking zones do not operate. Touch . Touch or of the timer to select the time. When the time elapses, the sound operates and flashes.

## Starting the STOP+GO

The function sets all cooking zones that operate to a keep warm setting.

- **Touch to start** this function. The symbol comes on.
  - **Touch to stop** this function. The heat setting that you set before comes on.
- does not stop the timer function.
- fully locks the control panel.

## Locking / unlocking the control panel

You can lock the control panel. It prevents an accidental change of the heat setting.

To start this function touch . The symbol comes on for 4 seconds.

The Timer stays on.

To stop this function touch . The heat setting that you set before comes on.

When you stop the appliance, you also stop this function.

## The child safety device

This function prevents an accidental operation of the hob.

Starting the child safety device

- **Do not set the heat settings.**
- Touch for 4 seconds. The symbol comes on.

Switching off the child safety device

- **Set the heat settings.** The symbol comes on. Touch until the symbol comes on.
- Touch .

Overriding the child safety device for one cooking session

- **Set the heat settings.** The symbol comes on. Touch until the symbol comes on. **Set the heat setting in less than 10 seconds.** You can operate the hob.
- The child safety stays active after switch off the hob.

## OffSound Control (Deactivation and activation of the sounds)

Deactivation of the sounds

Deactivate the appliance.

Touch for 3 seconds, sound operates. Touch , sound operates. Touch for 3 seconds. comes on, the sound is on. Touch , comes on, the sound is off.

When this function operates, you can hear sounds only when:

- the Minute Minder comes down
- The Count Down Timer comes down
- you put something on the control panel.

Activation of the sounds

Deactivate the appliance.

Touch  for 3 seconds. Touch  . Touch  for 3 seconds. .  comes on, because the sound is off. Touch  ,  comes on. The sound is on.

## HELPFUL HINTS AND TIPS

### Cookware



- The bottom of the cookware must be as thick and flat as possible.
- Cookware made of enamelled steel and with aluminium or copper bottoms can cause discoloration on glass ceramic surface.

### Energy saving



- If possible, always put the lids on the cookware.
- Put cookware on a cooking zone before you start it.
- Stop the cooking zones before the end of the cooking time to use residual heat.
- The bottom of pans and cooking zones must have the same dimension.

### Öko Timer (Eco Timer)



To save the energy, the heater of the cooking zone switches itself off earlier than count down timer signal. The heating time reduction depends on cooking level and cooking time.

### Information on acrylamides



According to the newest scientific knowledge, if you brown food (specially the one which contains starch), acrylamides can pose a health risk. Thus, we recommend that you cook at the lowest temperatures and do not brown food too much.

## CARE AND CLEANING

Clean the appliance after each use.

Always use cookware with clean bottom.



#### **WARNING!**

Sharp objects and abrasive cleaning agents will damage the appliance.

For your safety, do **not** clean the appliance with steam blasters or high-pressure cleaners.



Scratches or dark stains on the glass ceramic have no effect on how the appliance operates.

To remove the dirt:

1. – **Remove immediately:** melted plastic, plastic foil, and food with sugar. If not, the dirt can cause damage to the appliance. Use a special scraper for the glass . Put the scraper on the glass surface at an acute angle and move the blade on the surface .

- **Remove after the appliance is sufficiently cool:** limescale rings , water rings, fat stains, shiny metallic discolorations. Use a special cleaning agent for glass ceramic or stainless steel.
2. Clean the appliance with a moist cloth and some detergent.
  3. At the end **rub the appliance dry with a clean cloth.**

## WHAT TO DO IF...

Problem	Possible cause and remedy
You cannot activate the appliance or operate it.	<ul style="list-style-type: none"> <li>• Activate the appliance again and set the heat setting in 10 seconds.</li> <li>• You touched 2 or more sensor fields at the same time. Only touch one sensor field.</li> <li>• The Child Safety Device or the Lock or Stop+Go operates. See the chapter Operating instruction.</li> <li>• There is water or fat stains on the control panel. Clean the control panel.</li> </ul>
A Sound operates and the appliance deactivates. A sound operates when the appliance is deactivated.	You put something on one or more sensor fields. Remove the object from the sensor fields.
The residual heat indicator does not come on.	The cooking zone is not hot because it operated only for a short time. If the cooking zone should be hot, speak to the service centre.
The Automatic Heat Up function does not operate.	<ul style="list-style-type: none"> <li>• There is still residual heat on the cooking zone. Let the cooking zone become sufficiently cool.</li> <li>• The highest heat setting is set. The highest heat setting has the same power as the Automatic Heat Up function.</li> </ul>
You cannot activate the outer ring.	Activate the inner ring first.
The sensor fields become hot.	The cookware is too large or you put it too near to the controls. Put large cookware on the rear cooking zones if it is necessary.
There is no signal when you touch the panel sensor fields.	The signals are deactivated. Activate the signals (see OffSound Control).
[-] comes on	The Automatic Switch Off operates. Deactivate the cooking zone and activate it again after 60 seconds. If after 60 seconds [-] comes on again speak to the service centre.

Problem	Possible cause and remedy
E and number comes on.	There is an error in the appliance. Disconnect the appliance from the electrical supply for some time. Disconnect the fuse from the electrical system of the house. Connect again. If E comes on again, speak to the service centre.

If you tried the above solutions and cannot repair the problem, speak to your dealer or the Customer Care Department. Give the data from the rating plate, three-digit-letter code for the glass ceramic (it is in the corner of the cooking surface) and an error message that comes on.

If you operated the appliance incorrectly, the servicing by a customer service technician or dealer will not be free of charge, even during the warranty period. The instructions about the customer service and conditions of guarantee are in the guarantee booklet.

## ENVIRONMENT CONCERNS

The symbol  on the product or on its packaging indicates that this product may not be treated as household waste. Instead it should be taken to the appropriate collection point for the recycling of electrical and electronic equipment. By ensuring this product is disposed of correctly, you will help prevent potential negative consequences for the environment and human health, which could otherwise be caused by inappropriate waste handling of this product. For more detailed information about recycling of this product, please contact your local council, your household waste disposal service or the shop where you purchased the product.

### Packaging material



The packaging materials are friendly to the environment and can be recycled. The plastic components are identified by marking: >PE<, >PS<, etc. Discard the packaging materials as household waste at the waste disposal facilities in your municipality.







[www.aeg-electrolux.com/shop](http://www.aeg-electrolux.com/shop)

